

The all new Binks AA4400M air assisted airless spray gun has been designed with the operator and environment in mind.

This new gun will handle the toughest spray jobs in all industrial markets whilst providing the best fit, feel and the comfort operators demand. The spray gun is available with either HVLP or Trans-Tech© air caps operating at lower fluid and air pressures than competitors to achieve an exceptionally fine finish with superior paint savings and lower energy consumption.

This very versatile hand gun is ideal for spraying wooden products, furniture, heavy plant, commercial vehicle chassis, agricultural machinery, aircraft etc. Operator fatigue and the risk of RSi are considerably reduced due to the light weight, light trigger pull and gun styling.

Typical applications

- **Wooden Joinery and furniture**
- **Off road vehicles**
- **Aircraft**
- **Commercial vehicle chassis**
- **Skips and trailers**

Typical materials

- **Solvent and waterbased materials**
- **Stains, varnishes and lacquers**
- **Inks and dyes**
- **Sealers and undercoats**
- **Synthetic and enamel paints**

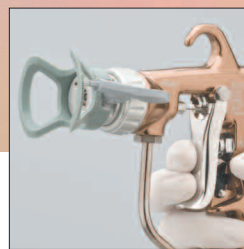

AA4400M
by **BINKS®**

Spray fan pattern is adjustable on the gun...

- Unique Trans-Tech or HVLP air caps provide a "Softer fine spray" for superior finish quality and higher transfer efficiency than competitors
- Lightweight and Operator friendly design with lighter trigger pull tension
- Easy to remove "in-line" needle assembly for quick maintenance
 - Adjustable needle packing and "balanced" air valve design
- Solid forged gun body for maximum durability and longer life
 - Stainless steel fluid passages with tungsten carbide seats
 - Gun handles Solvent and Waterborne coatings as standard
- Standard flat tip AND Twist tip cleaner available with a wide range of tips from .007" (0.18mm) to .035" (0.89mm)

AA4400M

by **BINKS**

3 different tip options available:

1. Flat Tip

Premium tips for a uniform spray pattern



2. Fine Finish Tip

Pre-orifice for best particle distribution and finish

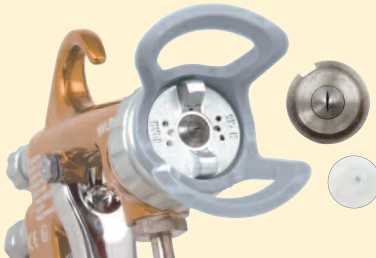

3. Twist Tip

Reduces downtime caused by tip blockages

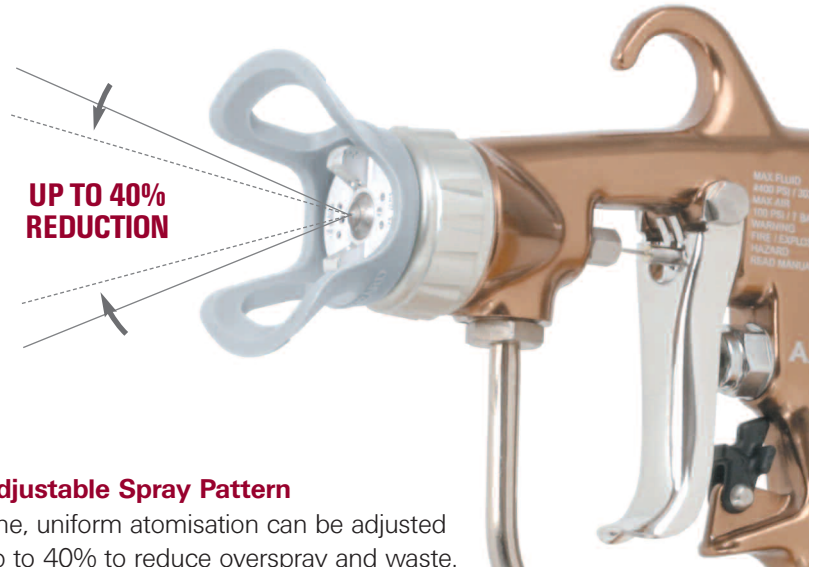
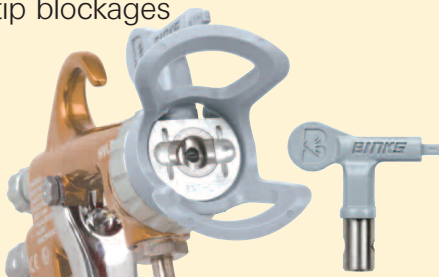

Adjustable Spray Pattern

Fine, uniform atomisation can be adjusted up to 40% to reduce overspray and waste.

- Easy to remove "IN-LINE" needle reduces repair time
- One tool trigger removal speeds up assembly and disassembly
- Adjustable needle packing can be tightened without disassembly
- HVLP or Trans-Tech atomisation technologies provide a wider choice of spray options
- Unique Twist Tip option quickly and easily removes blockages.

To change from flat tip to twist tip, you must (see Service Bulletin):

1. Replace Fluid Seat, Air Cap and Tip Guard
2. Add a Twist Tip brace

HVLP Flat Tip Parts

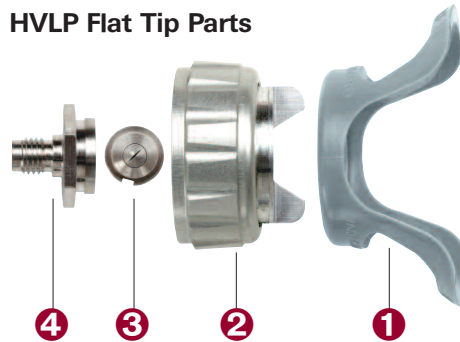

1. Flat Tip Guard (54-5794)
2. Flat Tip Air Cap 9X-H (54-5795-K)
3. Flat Tip (114-xxxx)
4. Tungsten Carbide Seat (54-5799-K)

HVLP Twist Tip Parts

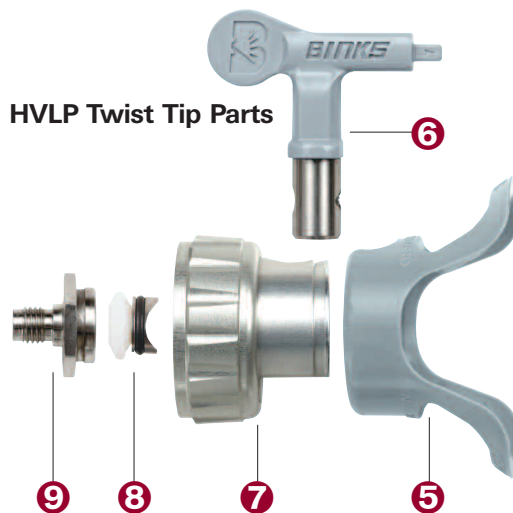

5. Twist Tip Guard (54-5793)
6. Twist Tip (9-xxx-75)
7. Twist Tip Air Cap 9XT-H (54-5796-K)
8. Twist Tip Brace (54-5801-K2)
9. Tungsten Carbide Seat (54-5832-K)

Spray Tip Selection Guides



Our premium tips for a uniform spray pattern.

For additional parts, refer to service bulletins 77-2921 & 77-2922.

To order AA4400M Standard Tips

insert the numbers from the chart into this part number: 114- ----

PREMIUM FLAT TIP	2" (51mm) fan width	4" (102mm) fan width	6" (152mm) fan width	8" (203mm) fan width	10" (254mm) fan width	12" (305mm) fan width	14" (356mm) fan width	16" (406mm) fan width	18" (457mm) fan width
.007" (0.179mm) orifice	00702	00704	00706	00708					
.009" (0.229mm) orifice	00902		00906	00908	00910	00912			
.011" (0.280mm) orifice		01104	01106	01108	01110	01112	01114		
.013" (0.330mm) orifice		01304	01306	01308	01310	01312	01314	01316	
.015" (0.381mm) orifice			01506	01508	01510	01512	01514	01516	01518
.017" (0.432mm) orifice			01706	01708	01710	01712	01714	01716	01718
.019" (0.483mm) orifice			01906	01908	01910	01912	01914	01916	01918
.021" (0.533mm) orifice					02110	02112	02114	02116	02118
.024" (0.610mm) orifice					02410	02412	02414	02416	02418
.027" (0.686mm) orifice					02710	02712	02714	02716	02718

Fan width based on 1000 PSI with water 12" (300mm) from surface. Actual results may vary, depending on material viscosity.

To order AA4400M Fine Finish Flat Tips

insert the numbers from the chart into this part number: 9- ---- -F

FINE FINISH FLAT TIP	9" (229mm) fan width	11" (280mm) fan width	13" (330mm) fan width	15" (381mm) fan width	17" (432mm) fan width
.009" (0.229mm) orifice	0909	0911			
.011" (0.280mm) orifice	1109	1111	1113	1115	
.013" (0.330mm) orifice	1309	1311	1313	1315	
.015" (0.381mm) orifice	1509	1511	1513	1515	1517
.017" (0.432mm) orifice	1709	1711	1713	1715	1717

Fan width based on 1000 PSI with water 12" (300mm) from surface. Actual results may vary, depending on material viscosity.



Includes a pre-orifice for the best particle distribution.



To order AA4400M Twist Tips

insert the numbers from the chart into this part number: 9- ---- -75

TWIST TIP	6" (152mm) fan width	8" (203mm) fan width	10" (254mm) fan width	12" (305mm) fan width	14" (356mm) fan width
.007" (0.179mm) orifice	307				
.009" (0.229mm) orifice	309	409	509		
.011" (0.280mm) orifice	311	411	511	611	
.013" (0.330mm) orifice	313	413	513	613	713
.015" (0.381mm) orifice	315	415	515	615	715
.017" (0.432mm) orifice		417	517	617	717
.019" (0.483mm) orifice		419	519	619	
.021" (0.533mm) orifice			521	621	
.023" (0.610mm) orifice			523	623	
.025" (0.636mm) orifice			525	625	
.027" (0.686mm) orifice				627	
.035" (0.890mm) orifice		435			

Fan width based on 2200 PSI with acrylic paint 12" (300mm) from surface. Actual results may vary, depending on material viscosity.



Turns to remove blockages quickly and easily.

When converting from flat tip to twist tip, increase pattern size by 2" and use air adjustment to turn down to original size.

Accessories

Description	Order Number
60 mesh* (kit of 5)	54-5788-K5
100 mesh (kit of 5)	54-5789-K5
Fluid Inlet Swivel (1/4"m x 1/4"f)	72-2332
Air Inlet push in tube fittings	54-5830-K3
Tungsten Carbide Seat Flat Tip	54-5799-K
Tungsten Carbide Seat Twist Tip	54-5832-K
Trans-Tech Air Cap Flat Tip (Cap code 9X-L)	54-5797-K
Trans-Tech Air Cap Twist Tip (Cap code 9XT-L)	54-5798-K

*60 mesh filters come standard with all guns.

Specification

Air and fluid inlet thread	1/4" Universal (M)
Fluid passageways	stainless steel
Gun weight	490 gm
Gun body	forged aluminium
Max working fluid pressure	303 bar (4400 psi)
Max air inlet pressure	6.8 bar (100 psi)
Seat	tungsten carbide

Inline paint filter insert available in two sizes:

* 60 mesh (kit of 5) pt. no. 54-5788-K5 and
100 mesh (kit of 5) pt. no. 54-5789-K5

*Fitted as standard with all guns.

AA4400M gun part numbers

0909-4400-HF0000	AA4400M Air assisted airless hand gun with HVLP air cap (Flat tip not included)
0909-4400-LF0000	AA4400M Air assisted airless hand gun with Trans-Tech air cap (Flat tip not included)
0909-4400-HT0000	AA4400M Air assisted airless hand gun with Twist Tip cleaner & HVLP air cap (no tip)
0909-4400-LT0000	AA4400M Air assisted airless hand gun with Twist Tip cleaner & Trans-Tech air cap (no tip)



Part number **AA4400M-75**

AA4400M Air Assisted Airless Spray Gun with air cap, tip and 7.5 metre AirFluid Hose for use with standard Binks MX & HP pump outfits.

ITW Industrial Finishing

Ringwood Road, Bournemouth, Dorset
England BH11 9LH
Tel: +44 (0)1202 571111
Fax: +44 (0) 1202 573488
Email: marketing-uk@itwifeuro.com

ITW Oberflächentechnik GmbH

Justus-von-Liebig-Strasse 31,
63128 Dietzenbach Germany
Tel: +49 (0) 6074-403-233
Fax: +49 (0) 6074-403-281
Email: marketing-de@itwifeuro.com

ITW Surfaces et Finitions

163-171 Avenue des Auréats, BP 1453
26014 Valence cedex FRANCE
Tel: +33(0)4 75 75 27 00
Fax: +33(0)4 75 75 27 59
Email: marketing-fr@itwifeuro.com